

EASYHYGY

TECHNICAL SPECIFICATIONS

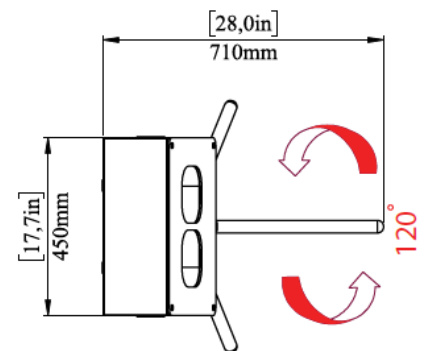
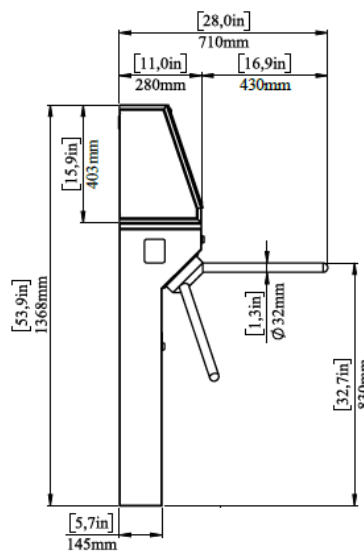
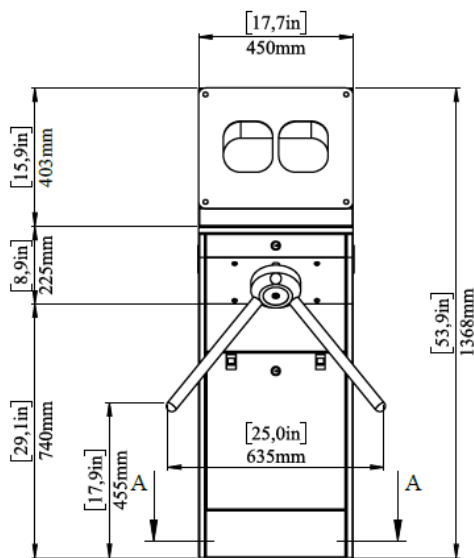

EASYHYGY

TECHNICAL SPECIFICATIONS

GENERAL SPECIFICATIONS

| | |
|---|---|
| Power | 110/220V. 50/60 Hz. AC (% \pm 10), 24 V DC. Single Unit : at stand-by ~10 W, during passage max. ~30 W |
| Dimensions | 280 x 450 x 1370 mm |
| Body Features | The body is made of 304-grade (opt. 316-grade) satin finished stainless steel. |
| Tripod arms | Q32 mm dia - Stainless Steel - Arms can be dismantled or mounted one by one separately |
| Rotor Systems | With rotating control; tripod arms are positioned at 120 degrees |
| Weight | ~45 kg |
| Operating Temperature, Humidity, IP Rating | -20° C / + 50° C, 0 / + 45° C (RH 95% not-condensing), IP54 Indoor |

SYSTEM SPECIFICATIONS

| | |
|-------------------------------|---|
| Control Systems | All inputs are opto-coupler protected. Controlled by dry contact or grounding input. Compatible with all access control systems that provide dry contact or grounding outputs |
| Passage Direction | Bi-Directional operation feature. Entrance-Exit |
| Output Data (Feedback) | The systems provides dry contact, NO - Normally Open, entry - exit passage feedback by relays |
| Time out Delay | Adjustable ; Operating Modes (7 - 14 - 21 second) |
| Flow Rate | 30 Passage / Minutes / Normally Standard |
| Emergency Mode | System allows free passage in emergency mode and in case of power failure |
| Indicators Features | Entrance - Green Arrow / Exit - Red Cross |
| Communication | RS 232 (Need PC Systems hardware serial port) |

EASYHYGY

TECHNICAL SPECIFICATIONS

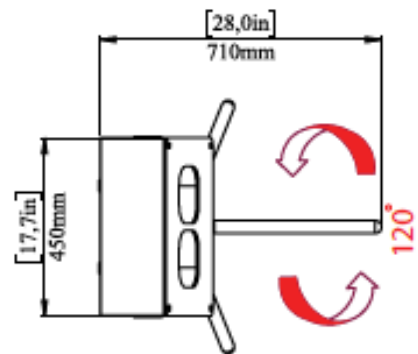
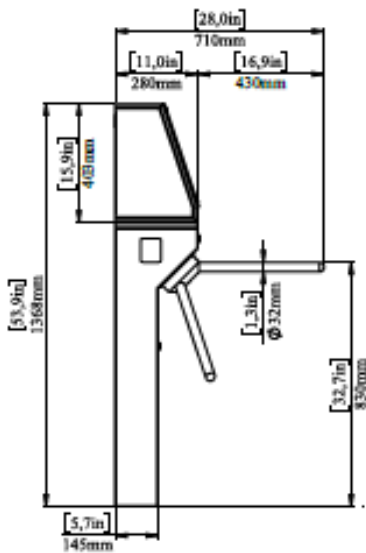
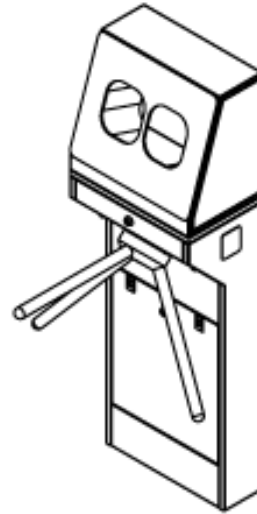
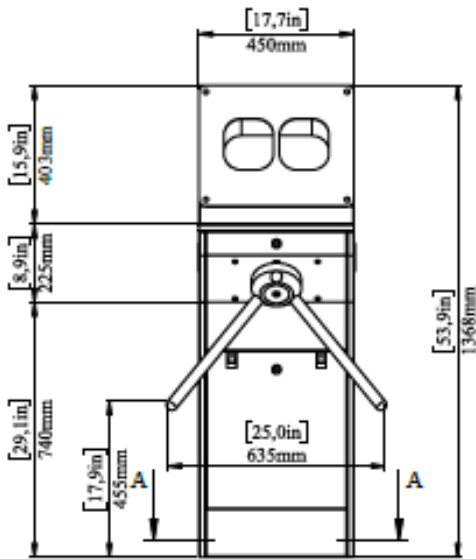

SECTION A-A

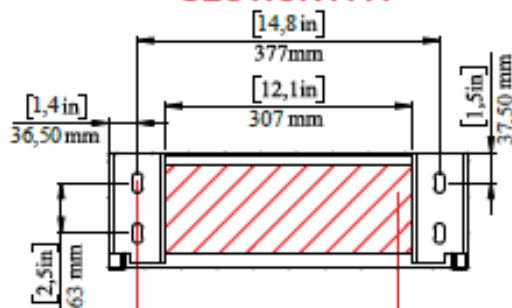

Ground Mounting Holes
M10x4

Cable Access
3x0.75 mm²

